

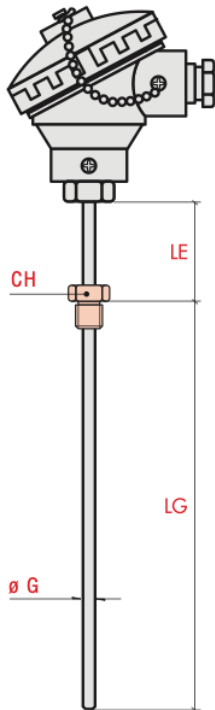

NOKEN s.r.l.
 info@noken-it.com
 www.noken-it.com



Low pressure sensors with connection head



Electrical connection



Mounting Fittings (For models without fixed attaching device only)

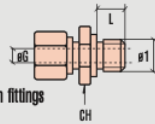

Suggested adjustable compression fittings

Material	ø1	L	CH	øG	Model
AISI 316	1/8" G	10.5	12	5	Z1 RFS-B/E050
	1/8" NPT	10.5	12	5	Z1 RFS-B/M050
	1/4" G	12	17	6	Z1 RFS-B/F060
	1/2" G	14	24	6	Z1 RFS-B/I060
	1/4" G	12	17	8	Z1 RFS-B/F080
	1/2" G	14	24	8	Z1 RFS-B/I080
Treated brass	1/4" G	12	17	6	Z1 RFS-O/F060
	1/2" G	14	24	6	Z1 RFS-O/I060
	1/4" G	12	17	8	Z1 RFS-O/F080
	1/2" G	14	24	8	Z1 RFS-O/I080

Flanges

Model	øG
Z2 FLS-A/A060	6
Z2 FLS-A/A080	8

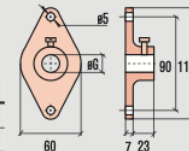

T1F1 Thermocouple

- Thermocouple Type K, S, B, E, R, J
- Range from 0 °C to +1600 °C
- Tolerance class 1 or 2 as IEC584, ANSI MC 96.1 standard or Special
- Hot joint : insulated, grounded
- Diameter from 3 mm to 21 mm (others on request)
- Sheath in AISI304 or AISI316 (others on request)
- Sheath length on request
- Aluminum head connection
- Inner connection with ceramic terminal block or temperature transmitter with 4/20 mA output - Fix or sliding compression fittings in AISI for process interface

Connection head	Diameter ø G mm	Base code	Thermocouple type	Element N° and limits	Hot junction	Sheath material	Sheath LG mm	Type of thread	Extension LE mm			
Cylindrical IP54 	5	F1 C50	L Fe - CuNi DIN/500°C max	0 Single Cl. 2 (standard)	0 Insulated 	B AISI 316	0100	S Without	00 Without			
	6	F1 C60										
	8	F1 C80										
Miniat. IP67 	5	F1 M50	J Fe - CuNi	1 Dual Cl. 2 (standard)	1 Grounded 	0150	D M10 x 1.5 x L13 CH - 14 (for ø5 and ø6)	05 50				
	6	F1 M60	K NiCr - Ni	2 Single Cl. 1 (special)	2 Exposed 	0200	E 1/8" Gas - L12 CH - 14 (for ø5 and ø6)	08 80				
	8	F1 M80		3 Dual Cl. 2 (special)		0250	F 1/4" Gas - L13 CH - 17	10 100				
Standard IP67, optional transmitter* 	5	F1 S50										
	6	F1 S60								0300	H 3/8" Gas - L15 CH - 22	
	8	F1 S80								0350	I 1/2" Gas - L15 CH - 24	
	5 + T	F1 T50								0400	M 1/8" NPT - L10 CH - 14 (for ø5 and ø6)	
	6 + T	F1 T60								0450	N 1/4" NPT - L13 CH - 17	
EEx d IIB IP65, optional transmitter* 	6	F1 X60										
	8	F1 X80								0500	Q 1/2" NPT - L15 CH - 24	
	6 + T	F1 U60										
	8 + T	F1 U80										
						L min	0050					

Note: other lengths on request for LG and LE. Code ex.: LG = 135mm Code 0135 / LE = 60mm Code 06

T1 F1 S60 - L 0 0 - B 0100 - S 00

